

PLAT OF SURVEY  
-OF-

LOT 22 OF THE ORIGINAL PLAT OF GENOA JUNCTION (NOW GENOA CITY)  
WALWORTH COUNTY, WISCONSIN, ACCORDING TO THE PLAT THEREOF,  
RECORDED IN THE OFFICE OF THE REGISTER OF DEEDS IN AND FOR THE  
SAID COUNTY OF WALWORTH AND STATE OF WISCONSIN.

SURVEY FOR: KONICEK, KAISER & SCHOLZE, S.C.  
SURVEY LOCATION: 114 S. FREEMAN STREET

- LEGEND
- FOUND IRON PIPE
  - SET IRON PIPE

"I hereby certify that I have surveyed the above described  
property and that the above map is a correct representation thereof  
and shows the size and location of the property, its exterior  
boundaries, the location of all visible structures and dimensions  
of all principal buildings thereon, boundary fences, apparent  
easements, roadways and encroachments, if any."

"This survey is made for the use of the present owners of the  
property, and those who purchase, mortgage, or guarantee the  
title thereto within one year from date hereof."



B.W. SURVEYING

412 N. PINE STREET  
BURLINGTON, WI 53105  
(414)-767-0225

SCALE:  
1" = 30'



S. FREEMAN STREET

66' WIDE

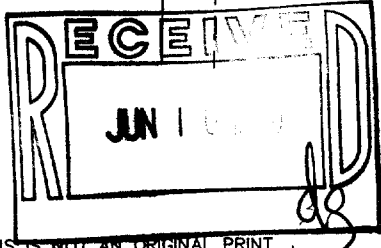
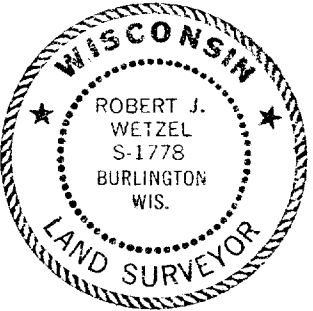
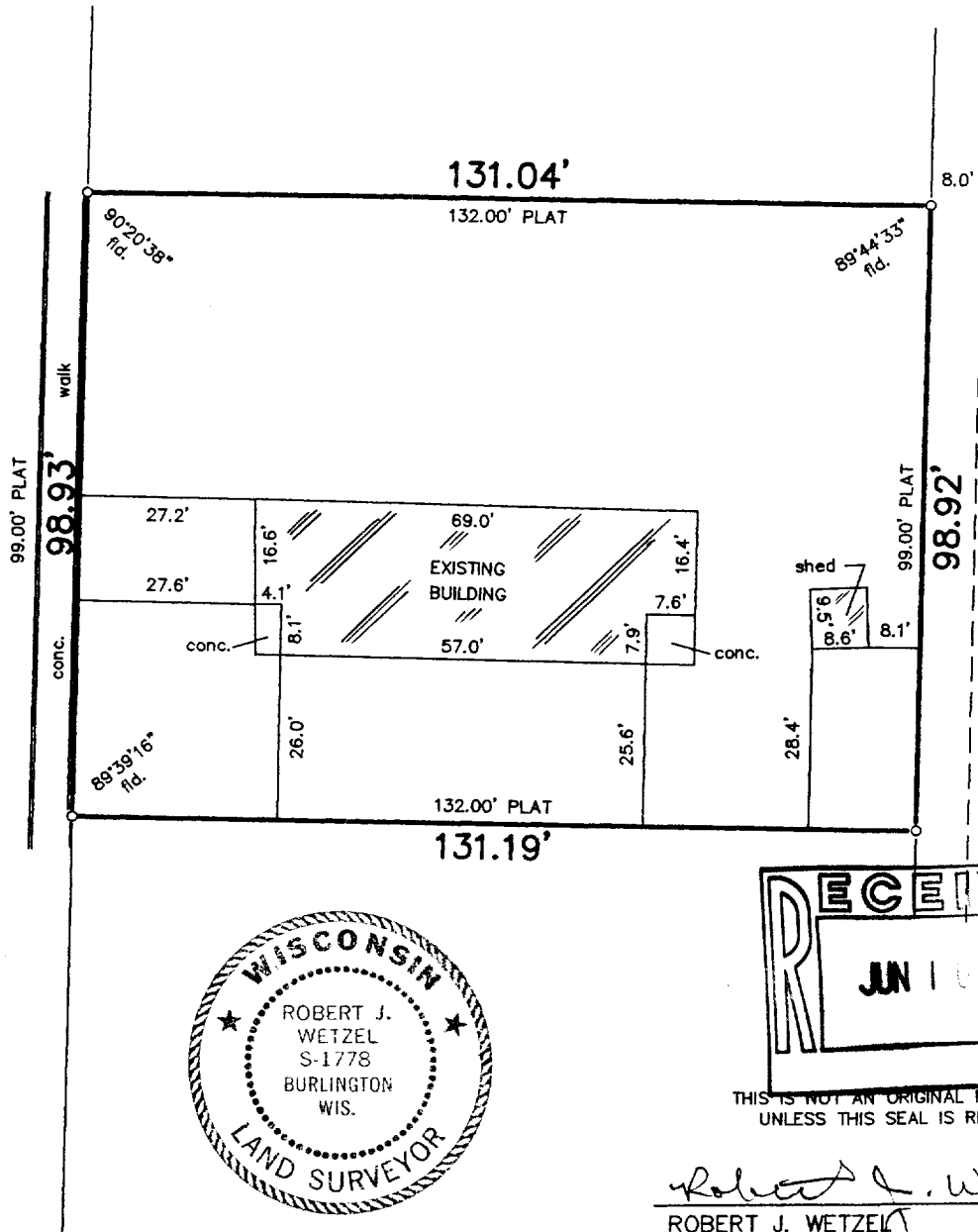

THIS IS NOT AN ORIGINAL PRINT  
UNLESS THIS SEAL IS RED.

*Robert J. Wetzel*  
ROBERT J. WETZEL S-1778

SEPTEMBER 11, 1998  
DATE

3655  
JOB NUMBER

006-636

TOP-33